

Waveguide Termination

WT42A



WR42, 17.6-26.7 GHz, 0.5 Watts, Square Cover Flange

Rev 3

Electrical

| | |
|-----------------------|------------------|
| Frequency Range | 17.6-26.7 GHz |
| VSWR | 1.05 max |
| Input Avg Power | 0.5 Watts @ 25°C |
| Operating Temperature | -40°C ~ +70°C |

Mechanical

| | |
|--------------------|--------------|
| Waveguide Size | WR42(R220) |
| Flange Type | IEC: UBR220 |
| Waveguide Material | Copper |
| Waveguide Finish | Grey painted |

Dimensions(mm)

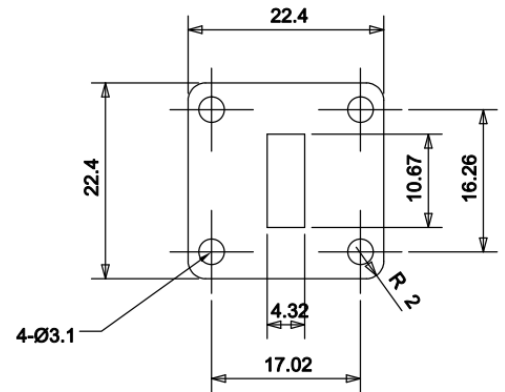
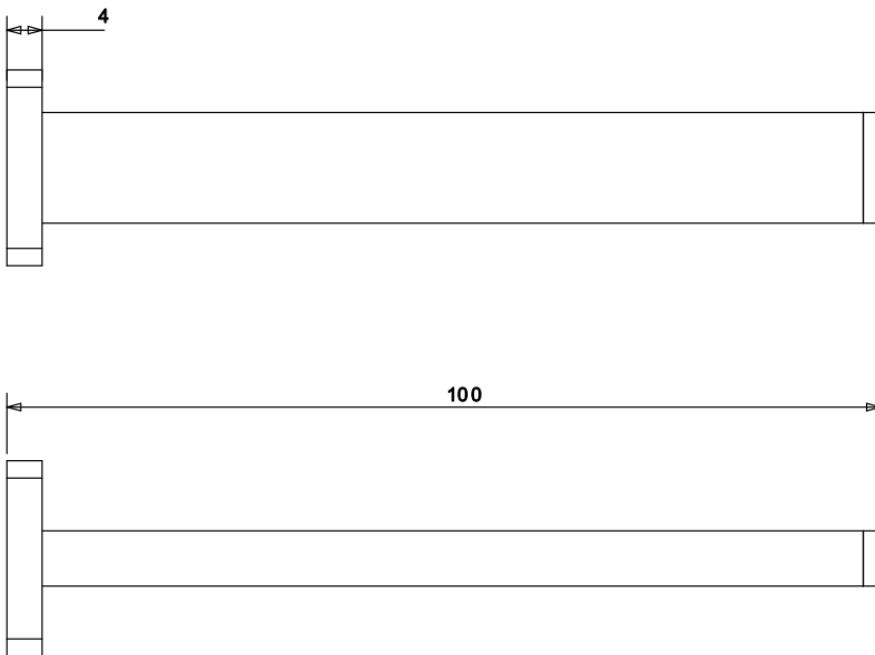



Typical Test Data

