

# Waveguide Termination

# WT28A50

WR28, 26.3-40.0 GHz, 50 Watts, Square Cover Flange



Rev 1

## Electrical

|                       |                 |
|-----------------------|-----------------|
| Frequency Range       | 26.3-40.0 GHz   |
| VSWR                  | 1.2 max         |
| Input Avg Power       | 50 Watts @ 25°C |
| Operating Temperature | -40°C ~ +70°C   |

## Mechanical

|                    |               |
|--------------------|---------------|
| Waveguide Size     | WR28(R320)    |
| Flange Type        | IEC: UBR320   |
| Waveguide Material | Aluminum      |
| Waveguide Finish   | Black painted |
| Heat Sink Material | Aluminum      |
| Heat Sink Finish   | Grey painted  |
| Net Weight         | Approx 95g    |

## Dimensions(mm)

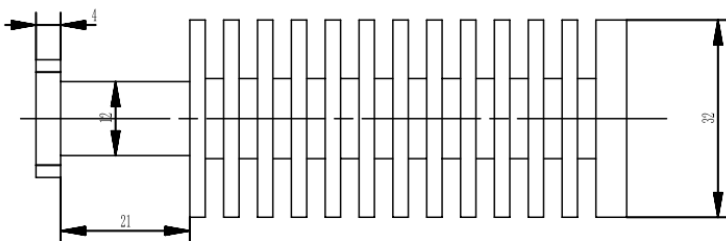
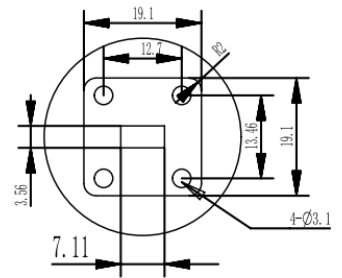
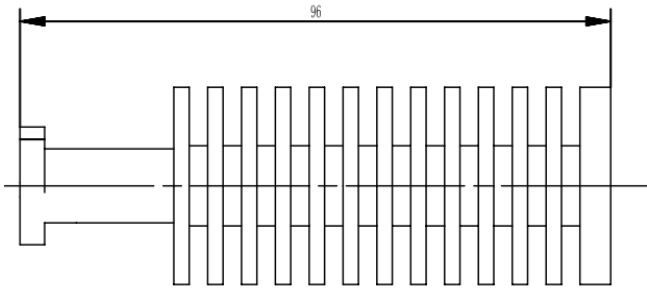

# Waveguide Termination

WT28A50

WR28, 26.3-40.0 GHz, 50 Watts, Square Cover Flange



Rev 1

## Typical Test Data

