



Electrical

Frequency Range	2.60-3.95 GHz
VSWR	1.03 max
Input Avg Power	10 Watts @ 25°C
Operating Temperature	-40°C ~ +70°C

Mechanical

Waveguide Size	WR284(R32)
Flange Type	IEC: UDR32
Waveguide Material	Aluminum
Waveguide Finish	Grey painted
Net Weight	Approx 750g

Dimensions(mm)

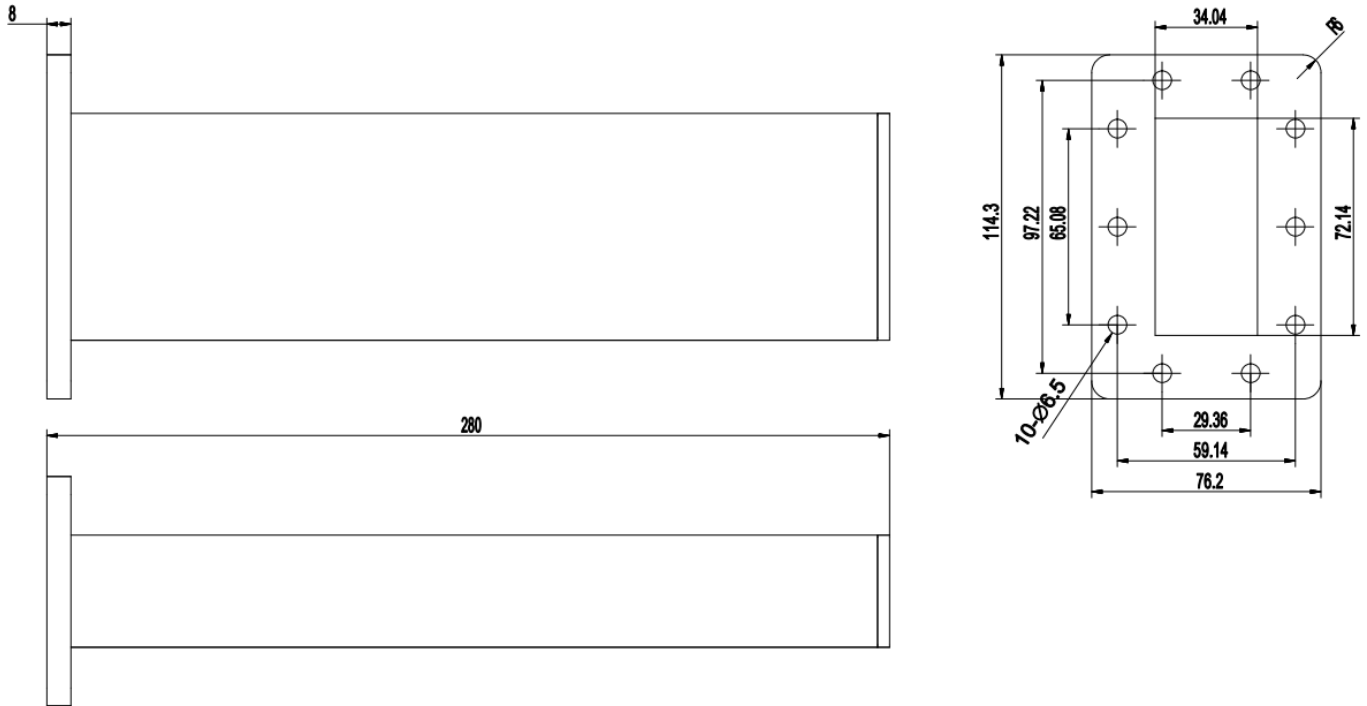



Waveguide Termination

WT284A

WR284, 2.60-3.95 GHz, 10 Watts, Rectangular Cover Flange

Rev 1

Typical Test Data

