



**WR34 to 2.92mm Female Waveguide to Coaxial Adapter
UG1530/U Flange, Right Angle**

Rev 5

Electrical

| | |
|-----------------|-------------|
| Frequency Range | 21.7-33 GHz |
| VSWR | 1.2 max |

Configuration

| | | |
|----------------|--------------------------|------|
| Waveguide Size | IEC | 260 |
| | EIA | WR34 |
| Flange | MIL3922/63-009(UG1530/U) | |
| Coax Connector | 2.92mm Female | |
| Body Geometry | Right Angle | |

Mechanical & Environmental

| | |
|-----------------------|---|
| Waveguide Body | Cu, acid pickling and passivation, anti-corrosive paint |
| Connector Body | Passivated stainless steel |
| Center Contact | Gold plated beryllium copper |
| Operating Temperature | -40°C to +85°C |
| Connector Interface | MIL-STD-348 |
| RoHS | Compliant under exemptions 6 (b) or 6 (c) |
| Net Weight | Approx 55g |

Note

* Paint in grey or black by default, other colors available.



**WR34 to 2.92mm Female Waveguide to Coaxial Adapter
UG1530/U Flange, Right Angle**

Rev 5

Dimensions(mm)

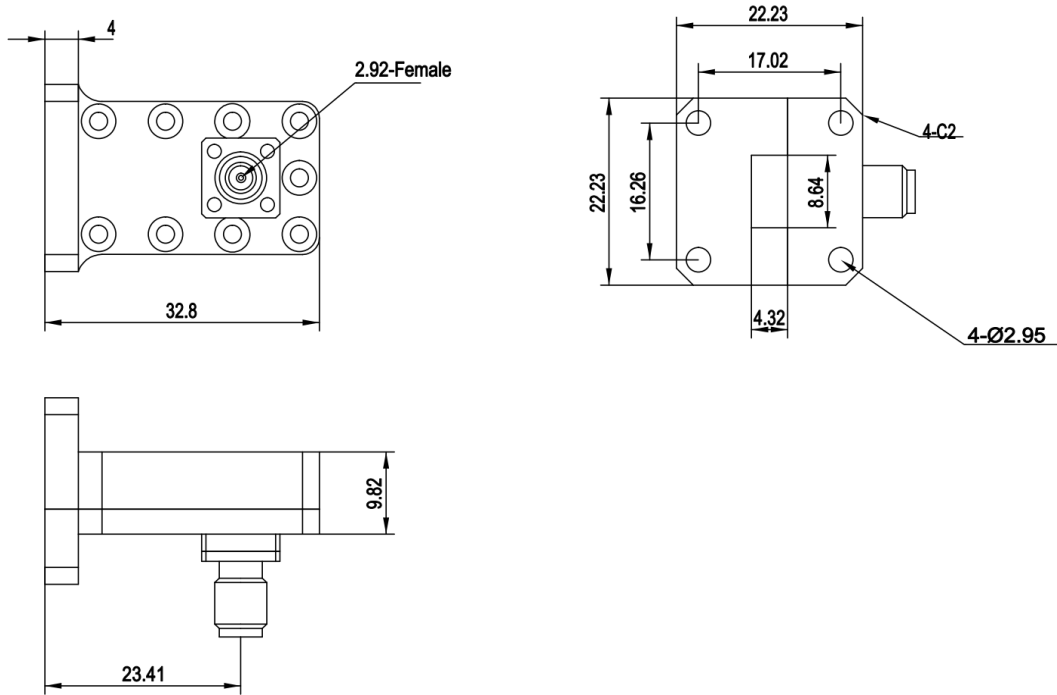

Flange Comparison (mm)

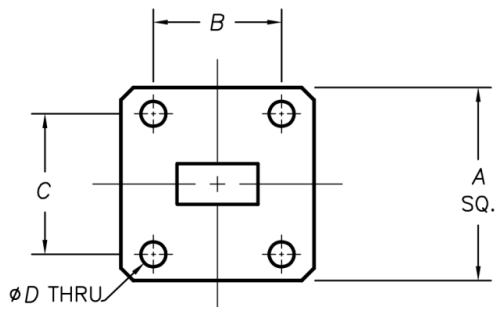

* The purpose of this comparison is to provide a quick reference of different flange standards. Great care has been given, nevertheless there might be a few mistakes.

* Please check the flange compatibility before ordering. Customized flanges are available.

| WG SIZE | CONFORMING STANDARD | A | B | C | D |
|---------|------------------------------|-------|-------|-------|------|
| WR34 | RF ONE:AWR34292A | 22.23 | 16.26 | 17.02 | 2.95 |
| | USA:MIL3922/63-009(UG1530/U) | 22.23 | 16.26 | 17.02 | 2.95 |



**WR34 to 2.92mm Female Waveguide to Coaxial Adapter
UG1530/U Flange, Right Angle**

Typical Test Data at 25°C

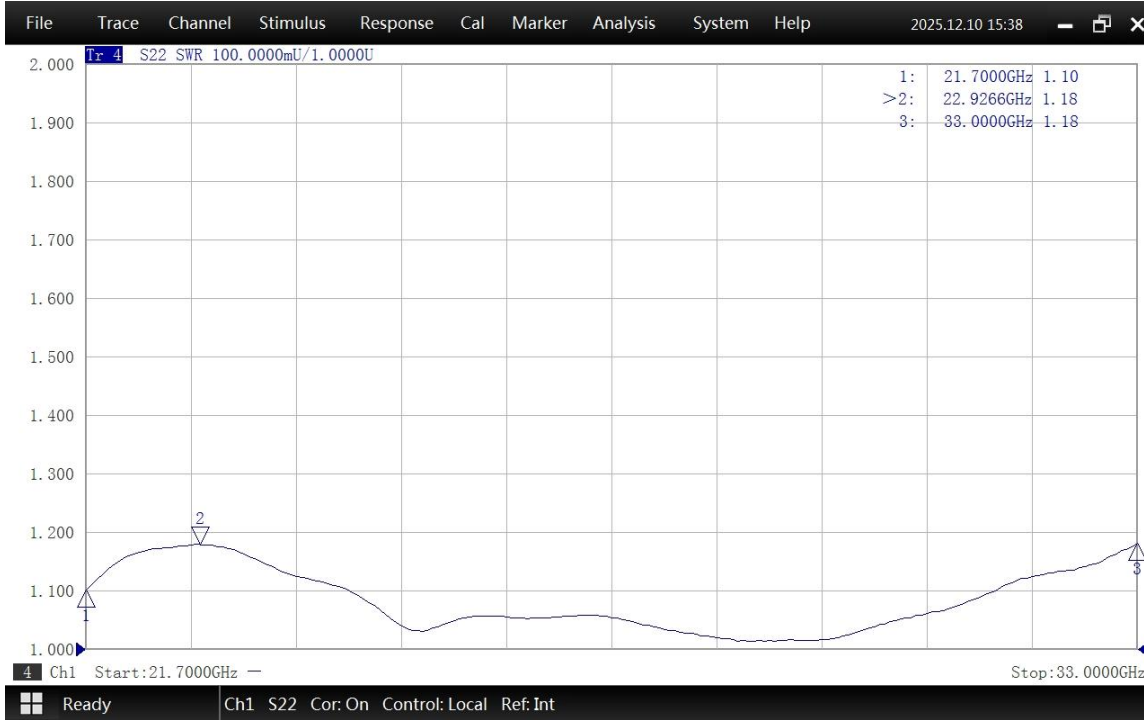

VSWR

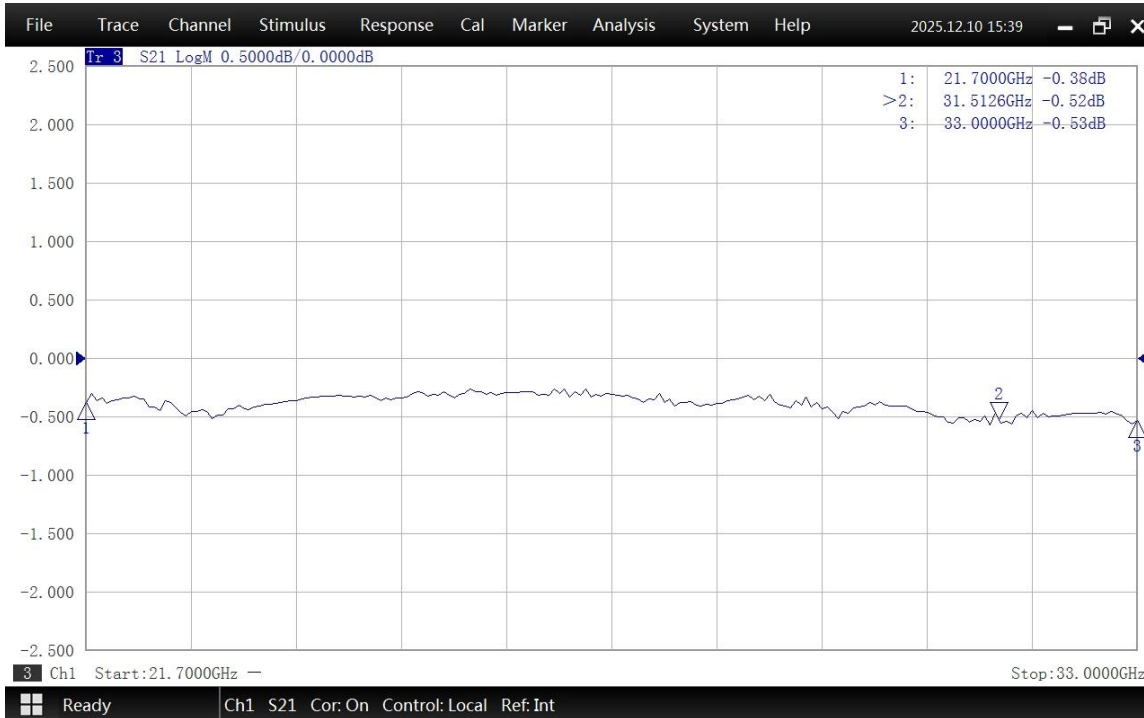

Insertion Loss*

* In Insertion Loss (IL) testing, adapters are measured back-to-back. To obtain the loss of a single adapter, divide the measured value by two.