

**WR112 to SMA Female Waveguide to Coaxial Adapter  
UBR84 Flange, End Launch**

Rev 5

**Electrical**

Frequency Range	6.57-9.99 GHz
VSWR	1.2 max

**Configuration**

Waveguide Size	IEC	R84
	EIA	WR112
Flange	IEC	UBR84
	North America	Al alloy: M3922/53-004(UG138/U) Cu alloy: M3922/53-002(UG51/U)
Coax Connector	SMA Female	
Body Geometry	End Launch	

**Mechanical & Environmental**

Waveguide Body	Aluminum, conductive oxidation, anti-corrosive paint
Connector Body	Passivated stainless steel
Center Contact	Gold plated beryllium copper
Operating Temperature	-40°C to +85°C
Connector Interface	MIL-STD-348
RoHS	Compliant under exemptions 6 (b) or 6 (c)
Net Weight	Approx 90g

**Note**

\* Flange size may not be 100% identical with the above listed standards, but are compatible. Refer to the next page for comparison table.

\* Paint in grey or black by default, other colors available.



**WR112 to SMA Female Waveguide to Coaxial Adapter  
UBR84 Flange, End Launch**

Rev 5

**Dimensions(mm)**

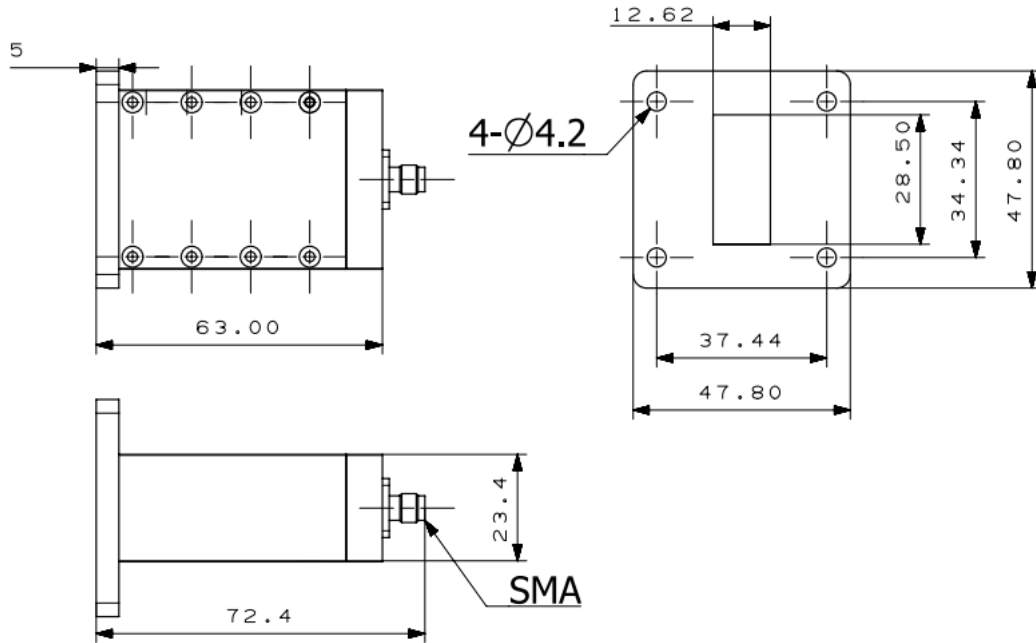

**Flange Comparison (mm)**

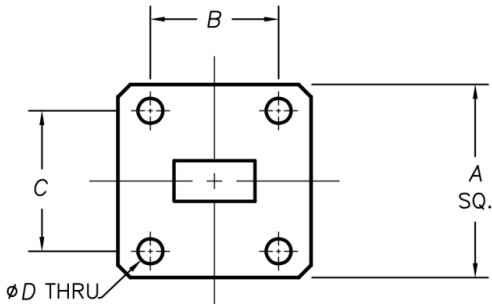

\* The purpose of this comparison is to provide a quick reference of different flange standards. Great care has been given, nevertheless there might be a few mistakes.  
\* Please check the flange compatibility before ordering. Customized flanges are available.

WG SIZE	CONFORMING STANDARD	A	B	C	D
WR112	RF ONE:AWR112SMAEL	47.8	34.34	37.44	4.2
	IEC60154:UBR84	47.80	34.34	37.44	4.17
	USA:MIL3922/53-004(UG138/U)	47.63	34.34	37.44	4.29



**WR112 to SMA Female Waveguide to Coaxial Adapter  
UBR84 Flange, End Launch**

**Typical Test Data at 25°C**

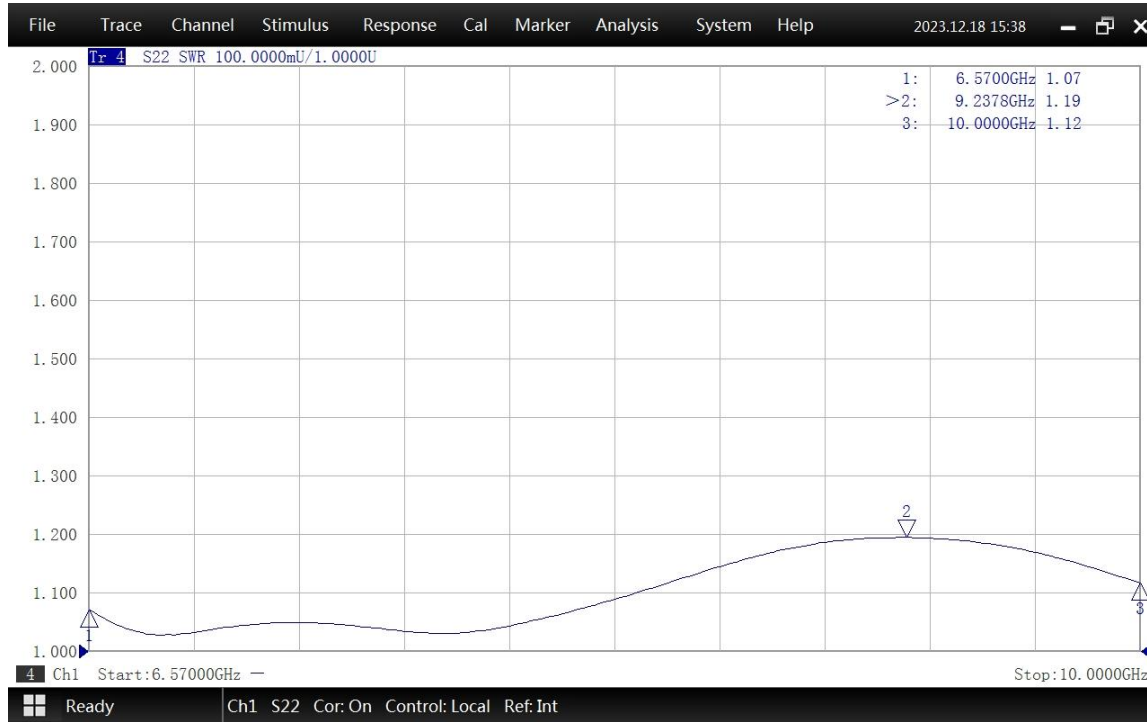

VSWR

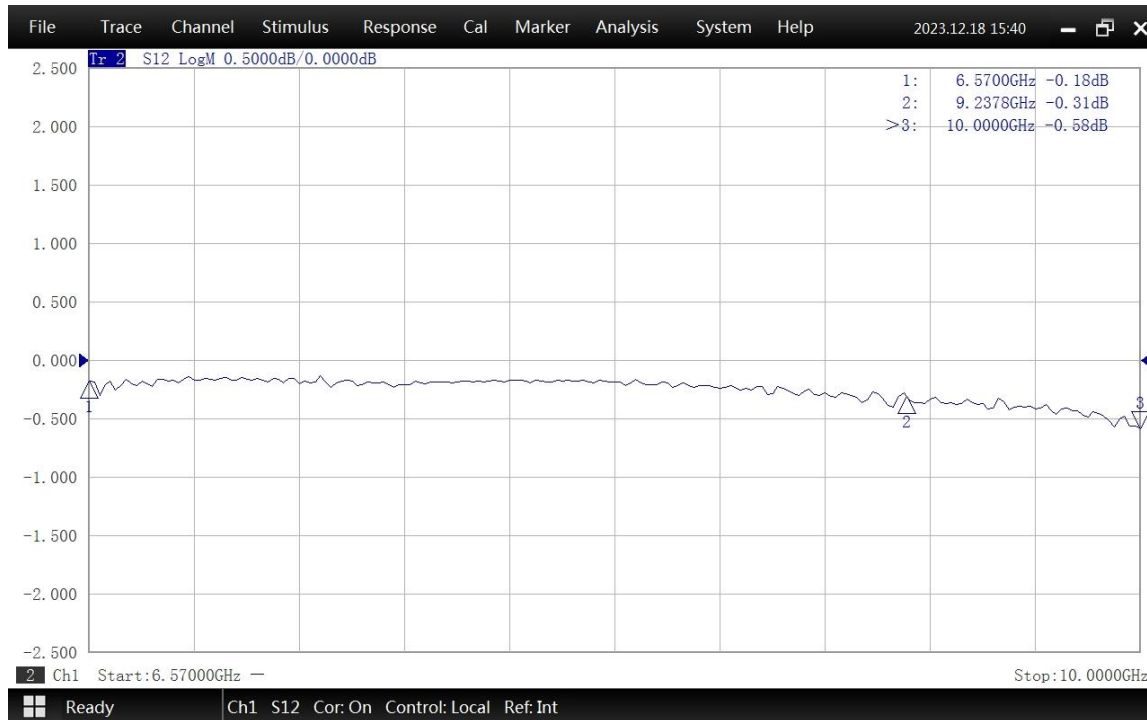

Insertion Loss\*

\* In Insertion Loss (IL) testing, adapters are measured back-to-back. To obtain the loss of a single adapter, divide the measured value by two.